

ENGINE

Mitsubishi FUSO 6M70-6AT4 Diesel (ADR 80/02)

Configuration: 6 Cyl. In-line OHC, 4 Valve
 Type: Turbocharged with Air to Air Intercooler, PCV, EGR & Common Rail Fuel System
 Displacement: 12882cc
 Bore: 135mm
 Stroke: 150mm
 Turbocharger: Variable Nozzle Vane Type
 Power (ECE R85-00): 309kW @ 2000 rpm
 Torque (ECE R85-00): 1770Nm @ 1100 rpm
 Maximum Engine Speed: 2200 rpm
 Compression Ratio: 17.5:1
 Oil Cooler: Plate Type, Water Cooled
 Air Cleaner: Dual Element Dry Paper Type with Vertical Intake & Air Restriction Indicator

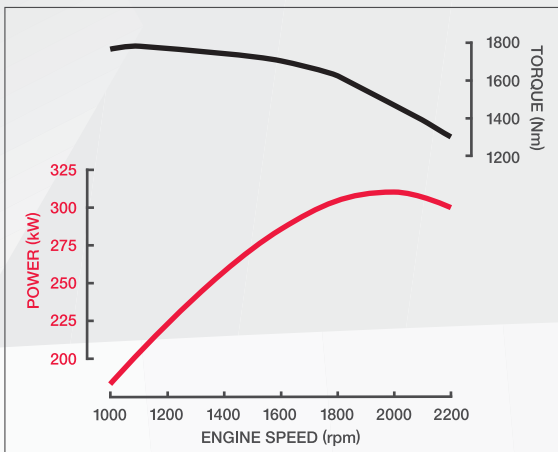

FUEL

Injection System: BOSCH Common Rail System
 Governor: Electronic, Speed Limited to 100 km/h
 Filtration: Main Filter & Water Separator
 Tank Type: Rectangular Aluminium
 Fuel Capacity: 400 Litres with Locking Fuel Cap

COOLING

Fan: 720mm dia. 10 Blades
 Fan Drive: Thermo Modulated
 Radiator: Corrugated Fin with Expansion Tank

ELECTRICAL

Voltage: 24V Negative Earth
 Alternator Capacity: 24V-50 amp
 Starter Capacity: 24V-5.5kW
 Battery Capacity: 2x12V, 150Ah/20hr
 Headlamp - Type: Rectangular Quartz Halogen
 - Capacity: Outer 2x75/70W
 Inner 2x70W

CLUTCH

Mitsubishi FUSO C14W40T

Disc Diameter: 400mm
 Type: Twin Dry Plate
 Operation: Air Assisted Hydraulic

TRANSMISSION

Eaton Fuller RTLO-16918B

No. of Speeds: 18
 Constant Mesh Type with Countershaft Brake
 Oil Cooler: Oil to Air
 Gear - Range:

	Low		High	
	Low	High	Low	High
Ratios - Low:	14.40	12.29		
- 1st:	8.56	7.30	2.29	1.95
- 2nd:	6.05	5.16	1.62	1.38
- 3rd:	4.38	3.74	1.17	1.00
- 4th:	3.20	2.73	0.86	0.73
- Rev.	15.06	12.85	4.03	3.43

 PTO Opening: Lower Transmission

PROPELLER SHAFT

Type: P152/P12
 Universal Joint: Needle Roller

FRONT AXLE

Mitsubishi FUSO F090T - KAI

Type: 2 x Reverse Elliot 'I' Beam
 Capacity: 13000kg (6500kg ea.)

REAR AXLE

Mitsubishi FUSO R10TT/R10T, D10HT/D10H

Type: Full Floating Hypoid, Tandem Drive with Inter-Axle Diff Lock
 Capacity: 21600kg
 Ratio: 4.625:1

STEERING

Type: Integral Power Assisted Ball & Nut
 Ratio: 22.4:1
 Steering Column: Tilt/Telescopic Adjustable with Lock



1

2

3

BRAKES

Type:	Full Air, Dual Circuit, Mitsubishi Taper Roller with Automatic Brake Adjustment
Size - Front:	410x150mm
- Rear:	410x200mm
Park Brake:	Rear Wheel Spring Actuated
Auxiliary:	'Powertard' Engine Brake
Trailer:	Hand Control Valve, Air Lines Coupling & Electrical Cable
Compressor:	Water Cooled, 340cc Single Cyl.
Air Dryer Model:	DU5

FRONT SUSPENSION

Type:	Load Sharing with Long Taper Leaf
Size:	1650x90mm Leaves
Shock Absorbers:	Double Acting

REAR SUSPENSION

Type:	Long Taper Leaf, 6 Rod Trunnion
Size:	1320x90mm Leaves

CHASSIS

Type:	Reinforced Parallel Channel
Size:	300x90x7.0mm
Width:	840mm
Tensile Strength:	540Mpa

WHEELS & TYRES

Wheel - Type:	13, Single Piece Disc
- Size:	22.5x8.25DC-165-12t
- Stud Pattern:	10x335mm PCD
Tyre - Size Front:	295/80R22.5 152/148M
- Size Rear:	11R22.5 148/145L
- Size Spare:	295/80R22.5 152/148M
Spare Tyre Carrier:	Provided

MASS (kg - estimated)

Model	Front	Rear	Total
FS52JS4RFAB	5665	3025	8690

Note: Mass (est.) includes oil and water but excludes spare wheel, tools & fuel.

INSTRUMENTS

Gauges:	Speedometer with Odometer & Tripmeter Tachometer Air Pressure (2) Fuel Level Water Temperature
Warning Lamps:	Turn Signal High Beam 'Powertard' Engine Brake Park Brake Trailer Brake Alternator Oil Filter Blockage Differential Lock Engine Control / Cruise Control (ECU) Air Filter Restriction Door Opening Warning Lamp/Buzzer: Air Pressure/Brake Dual Circuit Oil Pressure Engine Overheat/Low Coolant Level Engine Overrun Cab Tilt

CAB FEATURES

All Steel Forward Control

Type:	Elec/Hyd. Tilt 50 deg.
Mounting:	Coil Suspension, 4 Point
Colour:	Natural White
Interior:	Fully Trimmed
Windscreen:	Laminated Tinted
Windscreen Wipers:	2 Speed + Intermittent Cycle
Rear Vision Mirrors - RH:	Heated
- LH:	Remote/Heated with Convex Spotter
Seating Capacity:	3
Seat Belts:	2 ELR Lap Sash, 1 Lap
Seats - Driver:	Air Suspension with Auto Levelling Height Control 4 Way Adjustable with Lumbar Support Headrest & Fabric Trim
- LH:	2 Passenger Bench Type LH Headrest & Fabric Trim

MAX. LOADING

MAX. LOADING		
Front	Rear	Total
13000kg	21600kg	30800kg



5

1. New powerful, lower emission EGR engine compared to ADR 80/00 models.
2. Front panel access for quick and easy maintenance.
3. Spacious cab with climate control, CD player, cruise control, electric windows, central locking and loads of storage space.
4. Large lockable alloy fuel tank give excellent range between fills.
5. Air suspension driver's seat provides excellent comfort and support.

SPECIFICATIONS



STANDARD FEATURES

Driving

- Electric Windows
- Central Locking
- Climate Control
- Radio / CD Player
- Cruise Control (range 40 to 100 km/hr)
- Engine Idle Speed Control
- Opening Rear Quarter Glass
- Cup Holder
- Trailer Package (hand control valve, air line, coupling & electrical cable)
- Accessory Power Outlet / Cigar Lighter
- Fluorescent Cabin Lamp
- Interior Sun Visors

Storage

- Dash Storage Tray 2 DIN Glove Compartments
- Centre Storage Console
- LH Seat Storage Tray
- LH & RH Overhead Storage Pockets with Lid

Cab: External

- Door Side Impact Beams
- Halogen Fog Lamps
- Tinted Side & Rear Glass
- Roof Mounting Points (max. static load 50kg)
- Front End-Outline Marker Lamps
- Dual Air Horns

Chassis

- Tool Kit
- Chassis Mounted Tool Box
- Reverse Warning Buzzer

DIMENSIONS (mm)

		FS52JS
		4RFAB
Width	Front Fender:	2490
	Rear Axle:	2465
	Front Track:	2045
	Rear Track:	1850
Length	Frame:	840
	A Overall:	10140
	B Extreme Axle Spacing:	6530
	C Front Overhang:	1370
	D Wheelbase:	5870
	E Front Axle Spacing:	1860
	F Rear Axle Spacing:	1320
	G Front Axle to Rear of Cab:	770
	H Rear of Cab to Trailer Valve:	126
	I Frame, Trailer Valve to Rear Axle:	4974
	J Frame, Rear Axle to End:	2900
Height	N Overall:	3240
	O Air Intake to Cab Roof:	360
	P Cab to Ground:	2880
	Q Cab to Frame:	1900
	R Rear Frame to Ground:	1060
	Ground Clearance:	215

PERFORMANCE (Calculated - Paved Road)

Electronically Speed Limited to (km/h):	*100
Gradeability** at Rated GVM:	88.1%
Gradeability** at Rated GCM:	41.1%
Turning Circle (kerb to kerb):	21.4m

*Conforms to ADR 65/00

**This is Theoretical Performance (it may vary under different conditions).



WARRANTY

Basic/Powertrain - 3 Years, 200000kms, 4000 operating hours*
and 3 Years Cab Perforation/Anti Corrosion.
* whichever occurs first.

See www.fuso.com.au for full details.

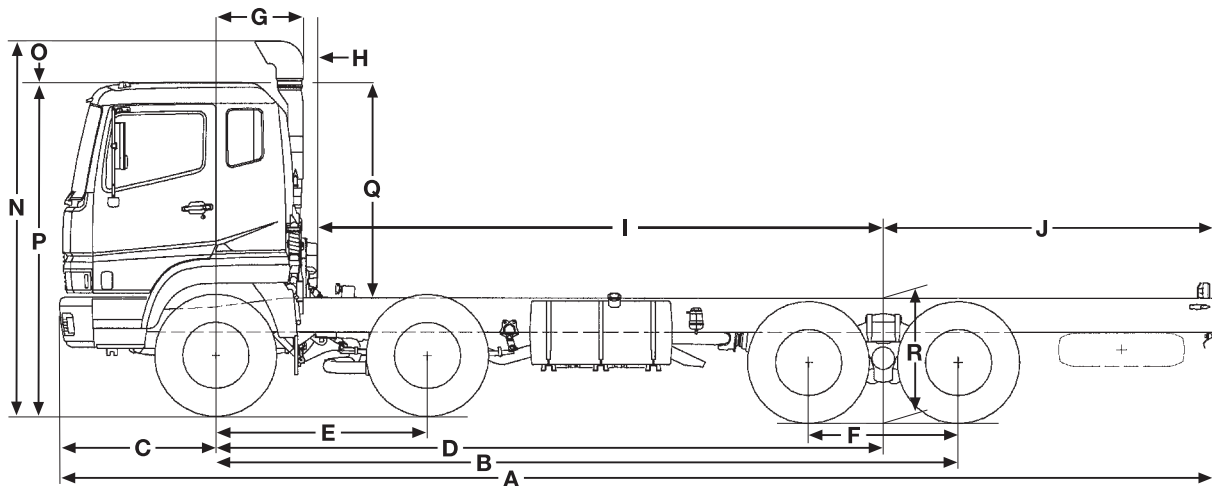

Note: Chassis reinforcement must be utilised for Tipper/Demountable type body configurations.

To conform with ADR 13/00 and 14/02 (lighting/mirror requirements) the following must be adhered to at body installation.

- If overall width exceeds 2.1 metres and other than a flat type or tipper body is fitted, rear end-outline marker lamps must be installed.
- If overall length exceeds 6.0 metres, side reflectors must be installed.
- If overall width exceeds 2.1 metres and length exceeds 7.5 metres, side marker lamps must be installed.
- If overall width is less than 2.2m, the mirrors must be modified to project not more than 230mm.

To conform with ADR 42/04 (General Safety), rear wheel guards must be fitted to the vehicle.

Unless specified in writing herein the accessories, applications, bodies or equipment depicted in this document are for illustration purposes only and may not be available from Mercedes-Benz Australia/Pacific Pty Ltd (ABN 23 004 411 410) ("MBAuP"). No representation or warranty whatsoever is given in relation to any accessories, applications, bodies or equipment or suitability of same that are shown herein that may be manufactured, supplied or fitted by a party other than MBAuP. MBAuP reserves the right without notice or obligation to discontinue or make changes to the colour, designs, materials and specifications of the products and options referred to herein at any time. For the most current information and in order to ascertain which accessories, applications, bodies and equipment are available from MBAuP please contact your authorised Mitsubishi FUSO truck and bus dealer. Fuso is a registered trademark of Mitsubishi Fuso Truck & Bus Corporation. Copyright © MBAuP. Reproduction in whole or part prohibited without written approval.

Date: Apr. '09 Part No. TSH58A



HEAVY DUTY

Trucks Built to Last



FS 8x4 SERIES

FS52J

309kW • 18 SPEED • 30800kg GVM • 53000kg GCM • ENGINE BRAKE

